

# SAFETY WARNINGS



READ AND SAVE THESE INSTRUCTIONS. TO REDUCE THE RISK OF FIRE, ELECTRIC SHOCK, OR INJURY TO PERSONS, OBSERVE THE FOLLOWING:

1. Ensure your power source conforms to the electrical requirements of this product.
2. Read all instructions before installing and using this product.
3. Do not attempt to hardwire this product. Performing any retrofitting actions may result in personal injury and/or electrical damage, and will void this product's warranty.
4. Be careful not to damage or cut the wire insulation (covering) during the installation. Do not permit wires to come in contact with any sharp edges.
5. This product must not be used or placed in potentially hazardous locations such as flammable, explosive, electrical, chemical-laden, or wet atmospheres.
6. Do not cover any power cords with rugs or other fabric materials.
7. Safety precautions should be exercised during the installation, operation, and maintenance of this product. After switching off, wait until all moving parts (if any) have come to a complete stop before servicing or cleaning.
8. Do not tamper with this product in any manner while it is in operation as it may cause electric shock, fire, or damage to this product.
9. This product is intended for indoor use only. Do not operate outdoors or in wet conditions.
10. Do not depend on the on/off programming as the sole means of shutting power from this product. Unplug the power cord before installing, servicing, or moving this product.
11. Do not operate this product while its cord is damaged, or if it malfunctions, has been dropped, or is damaged in any manner.
12. Keep this product out of reach of children and pets. Only allow operation under supervision if accessible.

# SAFETY WARNINGS



13. Do not dispose of this product with household waste. Dispose of it at an appropriate collection point for recycling electrical and electronic equipment, in accordance with Directive 2012/19/EU (WEEE).
14. This product complies with the essential requirements of Directive 2014/30/EU (EMC) and Directive 2014/35/EU (Low Voltage).

Manufacturer: AC Infinity Inc., 21880 Baker Parkway, City of Industry, CA 91789 USA  
EU Representative: THEMIS AR Unterstutzung UG (haftungsbeschränkt), Beedstrasse 54, 40468 Düsseldorf, Germany, legal@themisar.com  
EU Conformity: CE / RoHS / LVD / EMC / WEEE

# SICHERHEITSHINWEISE

LESEN UND BEWAHREN SIE DIESE ANLEITUNG AUF. ZUR VERRINGERUNG DES RISIKOS VON BRAND, ELEKTRISCHEM SCHLAG ODER VERLETZUNGEN BEACHTEN SIE DIE FOLGENDEN HINWEISE:

1. Stellen Sie sicher, dass Ihre Stromquelle den elektrischen Anforderungen dieses Produkts entspricht.
2. Lesen Sie alle Anweisungen sorgfältig durch, bevor Sie dieses Produkt installieren und verwenden.
3. Versuchen Sie nicht, dieses Produkt fest zu verdrahten. Jegliche nachträglichen Umbauten können zu Verletzungen oder elektrischen Schäden führen und führen ebenfalls zum Verlust der Garantie.
4. Achten Sie während der Installation darauf, die Isolierung (Ummantelung) der Kabel nicht zu beschädigen oder zu durchtrennen. Vermeiden Sie, dass Kabel mit scharfen Kanten in Kontakt kommen.

# SICHERHEITSHINWEISE



5. Dieses Produkt darf nicht in potenziell gefährlichen Umgebungen verwendet oder aufgestellt werden, wie z. B. in Bereichen mit brennbaren, explosiven, elektrischen, chemisch belasteten oder feuchten Atmosphären.
  6. Decken Sie keine Netzkabel mit Teppichen oder anderen Stoffmaterialien ab.
  7. Während der Installation, des Betriebs und der Wartung dieses Produkts ist besondere Vorsicht geboten. Warten Sie nach dem Ausschalten, bis alle beweglichen Teile (sofern vorhanden) vollständig zum Stillstand gekommen sind, bevor Sie Wartungs- oder Reinigungsarbeiten durchführen.
  8. Manipulieren Sie dieses Produkt nicht während des Betriebs, da dies zu elektrischem Schlag, Brand oder Beschädigung des Geräts führen kann.
  9. Dieses Produkt ist nur für die Verwendung in Innenräumen bestimmt. Betreiben Sie es nicht im Freien oder unter feuchten Bedingungen.
  10. Verlassen Sie sich nicht ausschließlich auf die Ein-/Ausschaltprogrammierung, um das Gerät vollständig vom Stromnetz zu trennen. Ziehen Sie immer den Netzstecker, bevor Sie das Produkt installieren, warten oder bewegen.
  11. Betreiben Sie dieses Produkt nicht, wenn das Netzkabel beschädigt ist, es Fehlfunktionen aufweist, heruntergefallen ist oder anderweitig beschädigt wurde.
  12. Halten Sie dieses Produkt außerhalb der Reichweite von Kindern und Haustieren. Eine Nutzung darf nur unter Aufsicht erfolgen, wenn das Gerät zugänglich ist.
  13. Entsorgen Sie dieses Produkt nicht über den Hausmüll. Bringen Sie es zu einer geeigneten Sammelstelle für Elektro- und Elektronik-Altgeräte gemäß Richtlinie 2012/19/EU (WEEE).
  14. Dieses Produkt erfüllt die grundlegenden Anforderungen der Richtlinie 2014/30/EU (EMV) und der Richtlinie 2014/35/EU (Niederspannung).
- Manufacturer: AC Infinity Inc., 21880 Baker Parkway, City of Industry, CA 91789 USA  
EU Representative: THEMIS AR Unterstutzung UG (haftungsbeschränkt), Beedstrasse 54, 40468 Düsseldorf, Germany, legal@themisar.com  
EU Conformity: CE / RoHS / LVD / EMC / WEEE

# PRODUCT CONTENTS

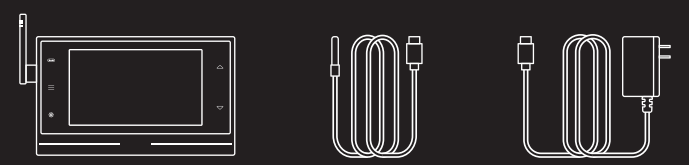

CONTROLLER AI+ CENTRAL HUB (x1)    SENSOR PROBE (x1)    POWER ADAPTER (x1)

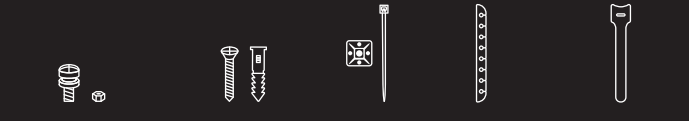

CONTROLLER PLATE BOLTS (x2)    WOOD SCREWS (x2)    WIRE TIE (x1)    CABLE DOCK (x1)    HOOK AND LOOP TIES (x2)

# POWERING AND SETUP

STEP 1 Plug the sensor probe into the controller's sensor port. Set the probe near your plants in your grow tent for the most accurate reading.



STEP 2 Plug the power adapter's UIS connector into the controller's power port. Plug the two-prong connector to an AC power outlet to power the controller.



STEP 3 Plug your device's connector into one of the controller's UIS ports. Do not plug it into the controller's power port.



Plug your device's power cord into an AC power outlet to power it.

Set your controller outside your grow tent so the onboard sensor can gather external climate readings.

# APP SETUP

CONNECT VIA BLUETOOTH

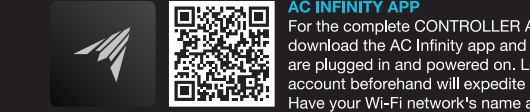

STEP 1 Tap on the "+" tab to add your smart device.

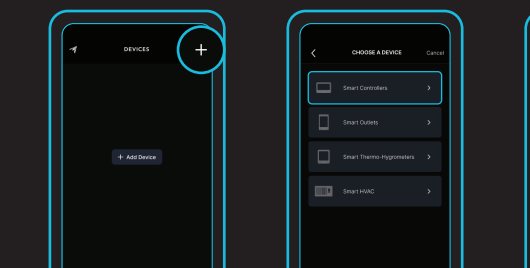

STEP 2 Select "Smart Controllers".



STEP 3 Select CONTROLLER AI+.



# APP SETUP

CONNECT VIA BLUETOOTH

STEP 4 Hold the port button for 5 seconds to activate Bluetooth. Wait for the Bluetooth icon to start flashing on your controller's screen to release the button.

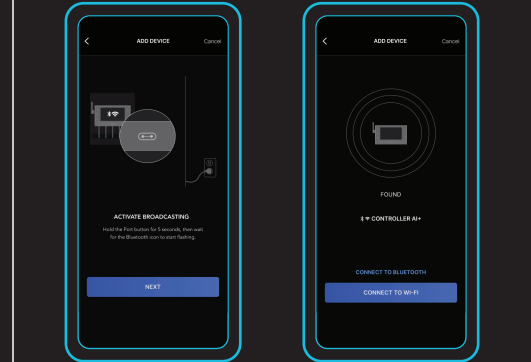

When pairing the app around multiple controllers, move your mobile device closer to your desired controller.

# APP SETUP

CONNECT VIA WI-FI

STEP 7 Repeat steps 1-5. Log in or create an account to continue.

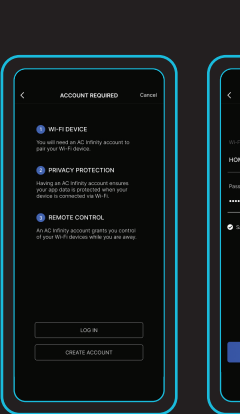

STEP 8 Enter your Wi-Fi network's password. You may also connect to an alternate 2.4 GHz router\*.

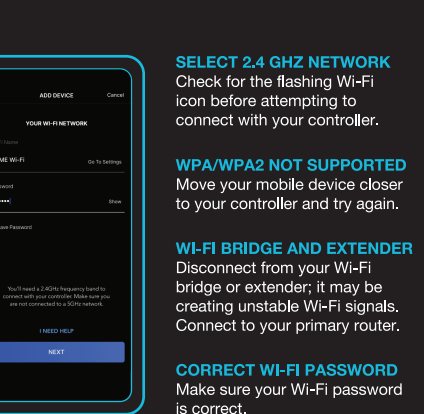

# APP SETUP

CONNECT VIA WI-FI

STEP 10 Tap the DONE button to complete the pairing process.

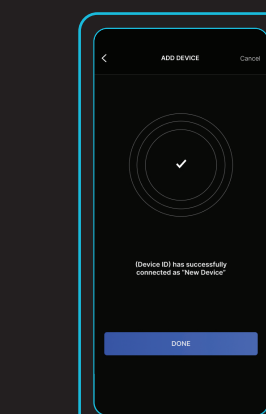

STEP 11 Your controller will appear in your smart device with a unique ID.

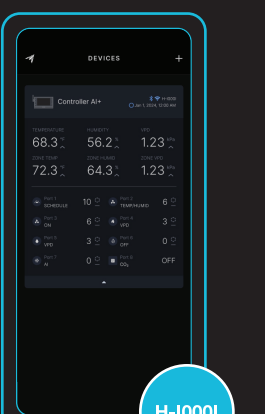

# AI SETUP

Once all your devices are connected, open the AC Infinity app and select your controller and your desired AI Mode (Beginner or Advanced) to get started.

You may select Advanced Mode for greater customization of climate targets and device parameters. To have these factors set for you, select Beginner Mode and follow these instructions.

STEP 1 Select Beginner Mode.

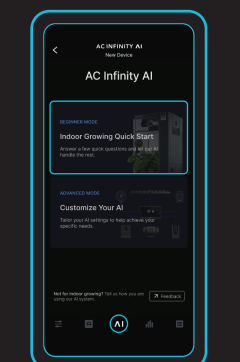

STEP 2 Select your plant.

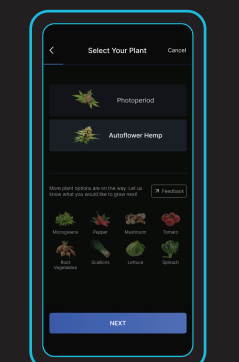

STEP 3 Select its growing stage.

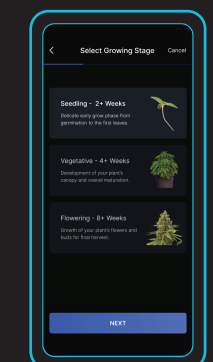

# AI SETUP

STEP 4 Select the devices you will be using.

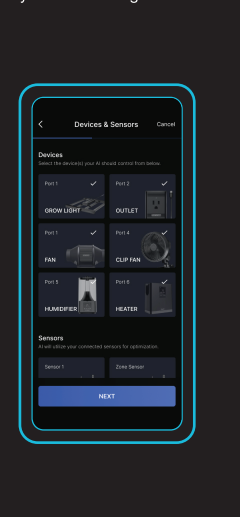

STEP 5 Designate your sensors' locations.

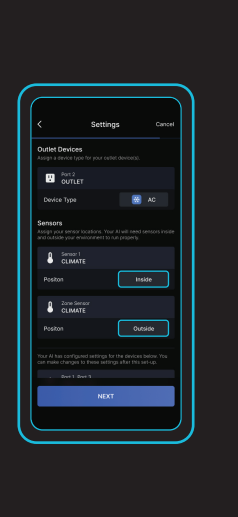

STEP 6 Review settings and tap START to finish setup.

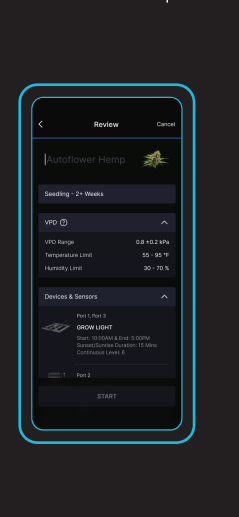

# SETTINGS

FACTORY RESET Hold the mode, up, and down buttons together for 5 seconds to reset your controller and restore factory settings.



CONTROLLER LOCK Hold the setting button to lock your controller in its current mode. Hold the setting button to unlock your controller.



HIDE SCREEN Lock your controller so no settings can be adjusted. See above. Then press the setting button to turn the display off. Pressing it again will turn the display back on.



JUMP TO OFF MODE Hold the mode button for 3 seconds in any mode or setting to automatically jump to OFF Mode.

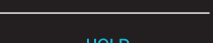

RESET TO OFF/DEFAULT Hold the up and down buttons together for 2 seconds to reset the value of your current mode or controller setting.

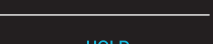

AUTO INCREASING OR DECREASING Hold the up or down button to increase or decrease the user setting automatically until you release them.



# MORE INFORMATION

PROGRAMMING Visit our website at [www.acinfinity.com](http://www.acinfinity.com) for more information on how to program CONTROLLER AI+.

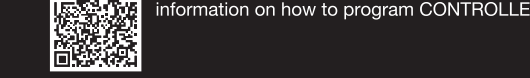

FAQ

WEBSITE | [www.acinfinity.com](http://www.acinfinity.com)  
EMAIL | [support@acinfinity.com](mailto:support@acinfinity.com)  
PHONE | 626-923-6399, 9 am to 5 pm PST  
ADDRESS | 21880 BAKER PARKWAY  
CITY OF INDUSTRY, CA 91789

WARRANTY

Our warranty program is our commitment to you, the original customer, that product sold by AC Infinity Inc. will be free from defects for TWO YEARS from the date of purchase. If you have any issues with this product, contact us and we'll happily resolve your problem or issue a full refund!

MANUAL CODE CTR89Q2410X1

COPYRIGHT © 2025 AC INFINITY INC. ALL RIGHTS RESERVED  
No part of the materials including graphics or logos available in this booklet may be copied, photocopied, reproduced, translated or reduced to any electronic medium or machine readable form, in whole or in part, without specific permission from AC Infinity Inc.

# CONTROLLER AI+

## QUICK START GUIDE

For the best experience, please download our app to program this controller.

